

www.planwell.co.uk

Planwell
roofing

Profile Roofing Manufacturers

Permaroof





**Manufacturers and
Nationwide Suppliers of
Permaroof
Box Profile
Metal Sheeting**

**BEST QUALITY
at BEST PRICES**

01542 832170

PERMAROOF

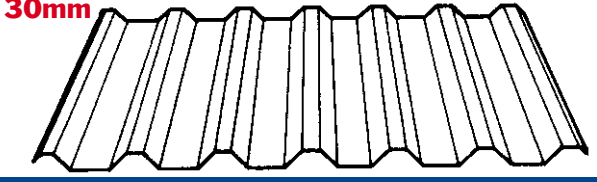
Permaroof Profile

PERMAROOF PROFILE (also available in reverse profile for vertical application) (sheet thickness available in 0.5 and 0.7)	CODE	'FULLY SUPPORTED' SIDE LAP	COVER WIDTH (mm)	PROFILE AVAILABILITY
MAXIMUM - "METRE WIDE COVER" SHEETING this includes the overlap 30mm 	PRS30		1000	AVAILABLE EX STOCK
PERMAROOF available in a variety of different finishes		PLASTISOL is a 'leathery grain' finish with a 200 micron coating on the front and a grey alkyd backing coat, available in a wide range of colours. POLYESTER is a smooth painted finish, available in a wide range of colours.		
THIS IS THE BEST VALUE FOR MONEY SHEET AVAILABLE				

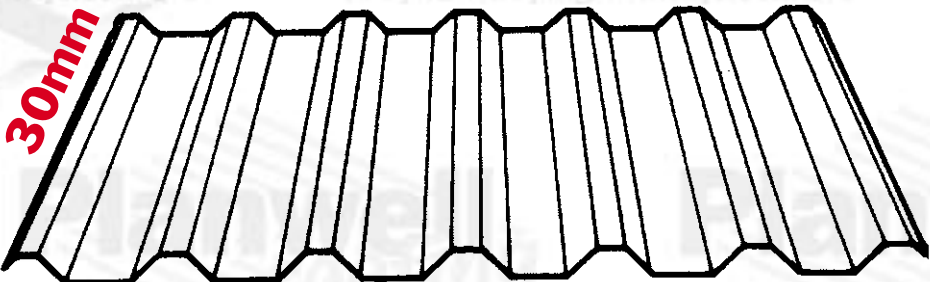
MAXIMUM - "METRE WIDE COVER" SHEETING this sheet covers a metre, including the overlap	
-------------------------------------------------------------------------------------------------------------	-------------------------------------------------------------------------------------

ADVANTAGES

- low cost
- 40 year *plus* sheet life expectancy
- maintenance free
- simple to fit (ideal for D.I.Y.)
with free fitting instructions provided
- strong enough to walk on
- attractive in appearance
- available in a wide choice of colours and finishes
- long sheet lengths available
manufactured to your individual requirements
- delivered throughout Scotland

buy direct from the manufacturer



LET THE LIGHT IN WITH PERMACLEAR

Whether you have a building, garage or shed which is dark or dim then simply 'let the light in' with our **PERMACLEAR** range of translucent sheeting. Available in profiles to match our permaroof metal sheets - **PERMACLEAR** is easy to fit, relatively cheap to buy and will give you the benefit of natural light for years to come.



Planwell roofing

Profile Roofing Manufacturers

Planwell's *affordable* **ROOFING**

Thank you for your recent enquiry about Planwell and our top quality Permaroof Sheeting.

This is our latest colour brochure on the Permaroof range of products.

If you are intending a roofing project in the weeks/months ahead then either telephone our office for an instant quote (Monday - Friday) or simply complete the 'Quick Quote' form (enclosed) and return it to our office by 'Freepost' (no need for a stamp). We will then work out exactly what materials you need and the prices, etc.

From our new base at Buckie we manufacture PERMAROOF sheeting, cut, folded, packaged and delivered at the right time and at the right price. Each order requires to be measured and quoted individually and proper, professional advice can be given on this and the correct roofing to suit your needs.

I trust we will be able to accommodate you on this occasion.

Yours faithfully

Murray Duncan

MANAGING DIRECTOR

**FREE
PROFESSIONAL
ADVICE
PHONE FOR AN
INSTANT QUOTE**



Inside the new Planwell factory, manufacturing Permaroof Sheeting

Permaroof Box Profile

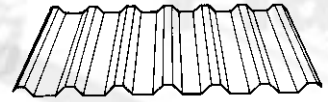

Metal Sheeting

Planwell roofing

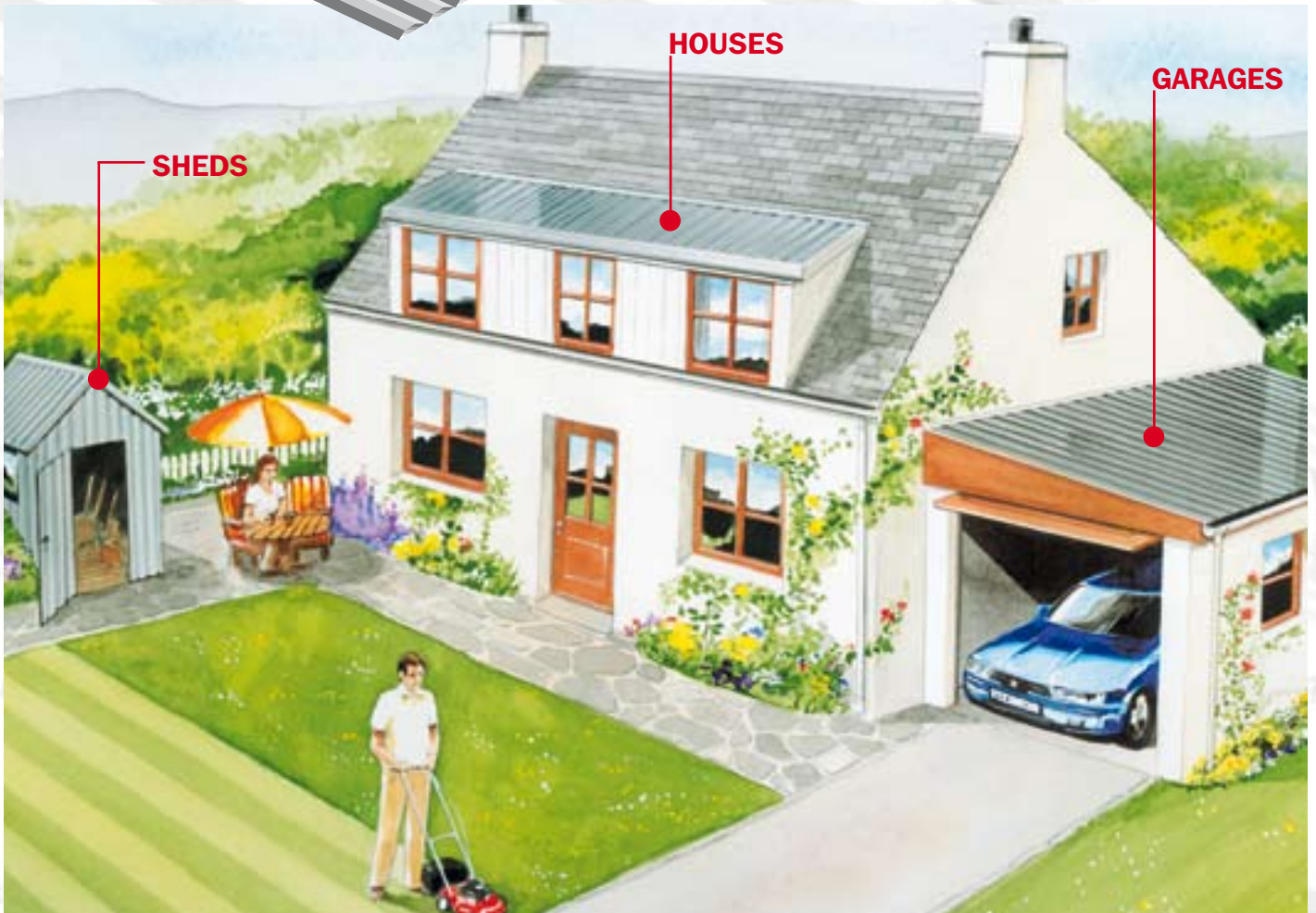

new roof from Planwell

There has never been a better time to think about a new or re-roofing project.

Planwell's **Permaroof** metal sheeting has proved its worth on thousands of projects throughout Scotland.

Maintenance free and with a sheet life expectancy of 40 years plus, **Permaroof** is ideal for nearly all roofing situations.

It lasts longer than old fashioned materials and is technologically superior to other roof sheet systems.

All roofing is manufactured to your individual requirements at the Planwell Factory and the finished roof will enhance the appearance of your property. **SO DON'T DELAY - ORDER TODAY**

PERMAROOF REALLY IS THE LONG TERM SOLUTION

Planwell's Permaroof

designed for . . .



HOUSES



D.I.Y.



GARAGES



INDUSTRIAL BUILDINGS



SHEDS



FUNCTION HALLS



FLAT ROOFS



SIDE CLADDING

only available from

PLANWELL

FREE
Permaroof Fixing Guide

FREE
Fixing Socket

FREE
Safety Gloves

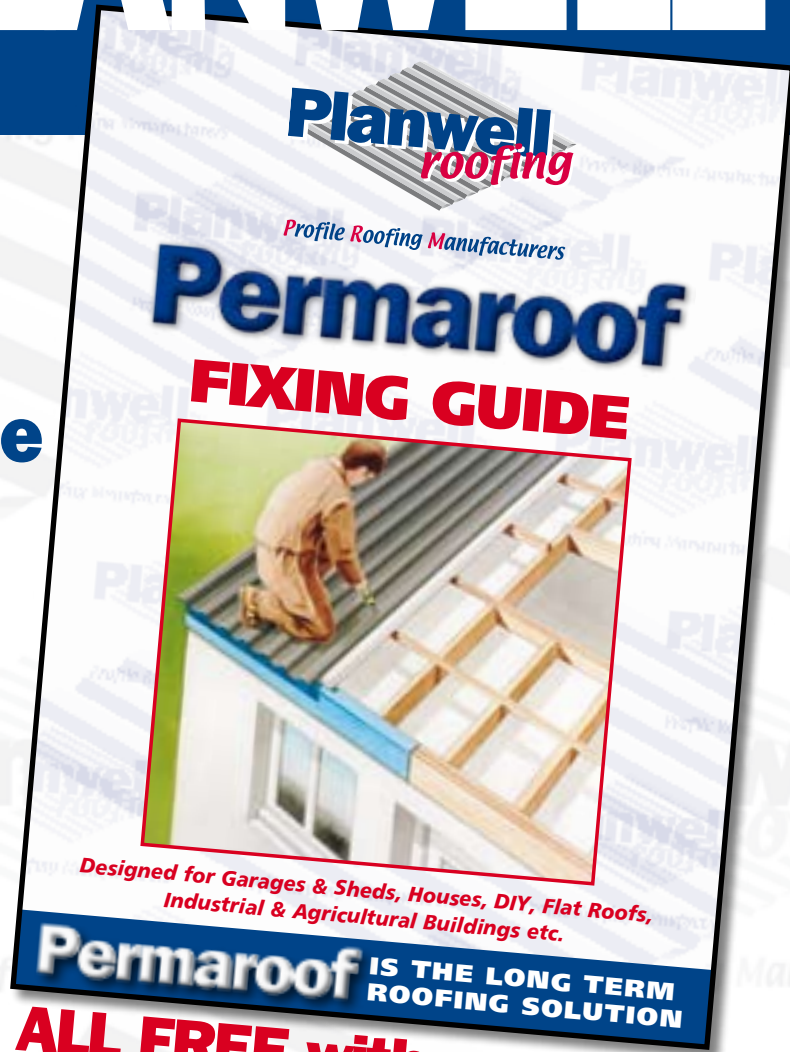

ALL FREE with each order placed



BEFORE



AFTER

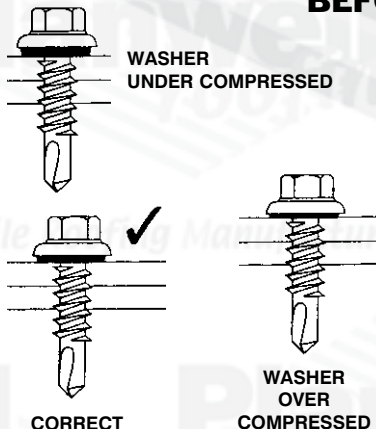

PERMAROOF SELF-DRILLING FIXINGS

FIXING TYPE	FIXING LENGTH	ALL VERY COMPETITIVELY PRICED TELEPHONE PLANWELL FOR DETAILS
TIMBER FIXING (SINGLE SKIN)	STANDARD FIXING - 32MM LONG	
STEEL FIXING (SINGLE SKIN)	STANDARD FIXING - 25MM LONG	
STITCHING SCREW (FOR FLASHINGS)	STANDARD STITCHER - 22MM LONG	

planwell's *customer profile*

PLANWELL ROOFING supply their 'permaroof' range of metal roof sheeting to thousands of customers every year throughout Scotland.

One very interesting project was recently in the small picturesque village of Portmahomack for Sandra and Stewart Smart who own luxury 'holiday home' type cottages which are rented out throughout the year by people from all over Britain.



DOLPHIN VIEW
PROPERTY
HOLIDAY HOMES

Dolphin View Properties recently built four new luxury cottages with each one sleeping up to six people at a time.

Stewart Smart said: "We needed a roofing product which would be **attractive in appearance**, would be **maintenance free** and of course **cost effective**. We contacted Planwell of Buckie and soon discovered that their service was first class. After looking through their colour brochure, we then decided on what we were looking for. After ordering from Planwell, our order was made-up and dispatched very quickly.

The actual installation of Planwell's roof sheets was so simple and we were able to complete each cottage within a matter of hours. **We are delighted with the finished roofs** and needless to say we have been recommending

Planwell Roofing to a great number of our customers since then".

Another satisfied customer for Planwell. Anyone interested in renting accommodation in this beautiful part of the Scottish Highlands should contact Sandra or Stewart on 01862 871576. www.dolphinview.co.uk



PLANWELL INSULATED

THE BEST CHOICE - FOR YOUR NEW ROOF

Planwell's Permaroof System can incorporate insulation for any new or re-roofing works.

Installation is quick and simple and involves fitting Planwell's rigid Insulation Boarding then fitting the Permaroof sheeting on top. This creates a "warm roof" system.

Having an insulated roof fitted has numerous advantages (see opposite page). The main advantages are:-

- Avoids condensation problems*
- Creates a warm, dry and usable room/garage
- Keeps the heat in a property (saves fuel bills / saves money)
- Reduces noise
- Adds value to your property
- Lasts a lifetime

An insulated "warm roof" system would normally be installed on the following:-

- Garages/workshops
- Houses
- Kitchens/bathrooms
- Bedrooms
- Offices
- Any roof where avoiding condensation is essential

It is important that you purchase the correct materials for your roofing project and that you receive proper advice.

With over 25 years experience in the roofing industry, Planwell's Co-Directors, Mark and Murray Duncan, offer free proper professional advice on all roofing projects from a standard shed roof to a new domestic or industrial building.

We have a freephone, free advice helpline (Monday to Friday) and can usually provide you with an instant quotation for your roofing requirements within minutes.

Planwell also have their own transport vehicles and provide a delivery service throughout Scotland.

**AN INSULATED ROOF - THE BEST CHOICE
FOR YOUR NEW ROOF**

TYPICAL DESIGN DETAILS Over Purlin Lining

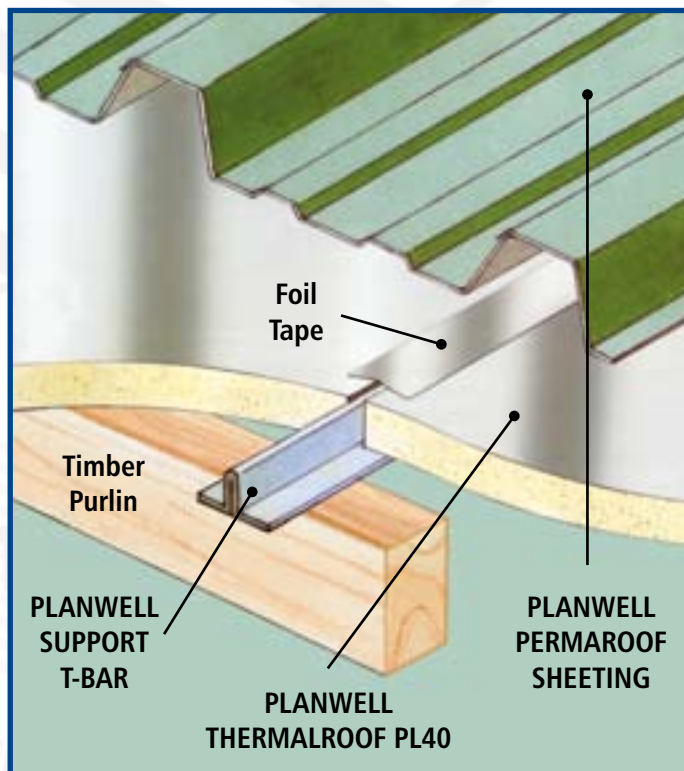

INSULATION DETAILS

Board Thickness - 40mm available from stock
(thicker boards are available if required)

Board Sizes - 1.2m x 2.4m

Appearance - Silver foil on both sides

Similar Products - Kingspan Thermaliner TL60

PLANWELL'S INSULATED ROOFING JUST LOOK AT THE DIFFERENCE

BEFORE



A TYPICAL LEAKING ASBESTOS ROOF

AFTER



**NEW PLANWELL INSULATED ROOF
- WARM & DRY INSIDE**

* WHEN INSTALLED AS PER MANUFACTURER'S WRITTEN INSTRUCTIONS



BEFORE - LEAKING



DURING - NEW ROOF BEING FITTED WITH INSULATION



AFTER - SEALED, WARM & DRY

THE BEST CHOICE FOR YOUR NEW ROOF

INSULATED ROOFING

"TICKS ALL THE BOXES"

- Eliminates condensation problems*
- Creates a warm, dry and usable room/garage
- Keeps the heat in your property
- Best quality at best prices
- Saves fuel bills saves £££s
- Reduces noise
- Adds value to your property
- Attractive internal appearance
- Saves energy, good for the environment
- Ideal for new and re-roofing works
- Quick and simple installation
- The thickness of insulation board can be increased if required
- Permaroof sheeting is available in a wide choice of colours, and in either Polyester or Plastisol finishes
- No "minimum order" charges
- Planwell - unbeatable quality at unbeatable prices, buy direct from the manufacturer
- Delivered throughout Scotland

www.planwell.co.uk

Planwell roofing

INSULATED ROOFING

INSULATION FOR ...

- GARAGES
- SHEDS
- HOUSES
- SIDE CLADDING
- DILLY & FLAT ROOFING

THE BEST CHOICE - FOR YOUR NEW ROOF

FREEPHONE PLANWELL ON **0800 02 88 272**

ELIMINATES CONDENSATION PROBLEMS *

* SEE PLANWELL'S INSULATION BROCHURE FOR MORE DETAILS

AVAILABLE IN A WIDE CHOICE OF COLOURS



GOOSEWING GREY MERLIN GREY SLATE BLUE TERRACOTTA RED VANDYKE BROWN OLIVE GREEN JUNIPER GREEN MOORLAND GREEN BLACK

The colours listed above are as a guidance only, due to pigment variations in the printing process the colours may not be exact. For the exact colour please contact Planwell for colour sheet samples. Please note certain colours are only available in Plastisol finish, check with Planwell for further details.



Answers to the most common Questions we are asked

Q WHAT IS PERMAROOF?

A Permaroof is profile metal roof sheeting, modern and attractive in appearance

Q WHAT CAN PERMAROOF BE USED FOR?

A Permaroof is designed for and used on Houses, Garages, Sheds, Industrial and Farm Buildings, Sports Stadiums, D.I.Y., etc.

Q IS PERMAROOF EXPENSIVE?

A No - Permaroof is a very competitively priced, affordable product, probably the most cost effective that money can buy - phone Planwell today and you will be pleasantly surprised!

Q HOW DO I KNOW THAT I AM BUYING AT THE BEST PRICE?

A Planwell are Rollformers, this means that you are buying direct from the manufacturer - **best materials - best prices**

Q WHAT IS THE LIFESPAN OF PERMAROOF?

A When installed correctly Permaroof is expected to remain **maintenance free** for between 20-30 years - a lifetime for most people - and has a sheet life expectancy of 40 years plus.

Q WHO INSTALLS IT?

A Installation of Permaroof is quite simple - and it is ideal for D.I.Y. enthusiasts, but if you need someone locally to install Permaroof for you, then we recommend you contact any reputable joiner or roofing contractor in your area.

Q WHICH PROFILE IS BEST?

A From the new Permaroof range the **30mm profile** provides the best value for money as it is the maximum 'metre wide cover' sheet - it is also the strongest from this range - and is rollformed at the Planwell Factory so is available ex-stock. Other profiles are featured in the Permaroof range but these are **not available ex stock** - so your order may not be processed as quickly.

Q WHAT LENGTHS ARE AVAILABLE?

A Permaroof is available in **long single sheet** lengths of almost any size, please phone Planwell for more details.



PERMAROOF - strong enough to be walked on

"Planwell provides top quality materials delivered at the right time and the right price."

Murray Duncan

MANAGING DIRECTOR

Q SHOULD I CHOOSE THE POLYESTER OR PLASTISOL COATED SHEETING?

A Polyester is the choice of most customers, it is a smooth painted finish and is used on all roofing applications. **Plastisol** is a more expensive “leathery grain” type coating.

Q WHAT'S THE BEST TYPE OF ROOF AVAILABLE?

A An insulated roof is always best as it avoids any possible condensation problems and has many advantages such as keeping heat in, saving fuel bills, reducing noise etc.

Q WHAT THICKNESS IS BEST?

A 0.5 thick is the most commonly used (for example if the ‘purlin’ spacings are at 4 ft. (1.2m) centres). 0.7 thickness is used if the purlin spacings are wider apart or for heavier industrial use.

Q WHAT IS THE RECOMMENDED MINIMUM FALL/SLOPE?

A The recommended minimum fall/slope is 5°.

Q DO THE ‘RIDGE’ TYPE FLASHINGS FIT INTO THE SHAPE OF THE SHEET?

A No. The permaroof flashings are made to the size and angle that you require and are fixed on top of the roof sheets along with Planwell’s ‘All Weather Fillers’ which are fitted so as to close off the spaces from wind and rain, birds, etc.

Q DO THE FIXINGS FIT IN THE FLAT OF THE SHEET?

A Yes, they are modern, **high performance fixings** which come with a special sealed washer - so they will not leak. They are fitted in the flat of the sheet so as to provide the best resistance to uplift from high winds.

Q WHAT TYPE OF FIXINGS DO I REQUIRE AND HOW MANY?

A This depends on the type of application. We will advise which type and will provide the proper fixings required as well as working out how many you require, etc. For further information phone the Planwell Technical Helpline today.

Q HOW DO I ORDER?

A Please complete and return the FREEPOST quickquote form. We will then work out what materials you require, what the total cost will be and we can then arrange your order from there. You can also receive an instant quote by telephone (Monday - Friday) or you can email your details to our office and we will work out a quote for you.

Q WHAT ARE THE PAYMENT TERMS?

A Planwell is a cash and carry business, providing you, the customer with the best materials at the best prices. Our normal terms are therefore payment in full before your order can be dispatched.

Q HOW QUICKLY WILL MY MATERIALS BE DELIVERED?

A From the time that we receive payment in full - your order will be very quickly manufactured and dispatched (normally within a few days, please phone Planwell for exact details on delivery of your order).

We hope we have covered most of the questions that are normally asked. If however, you need more details/information on anything else then please do not hesitate to contact Planwell today.

**BEST QUALITY
at BEST PRICES**



PERMAROOF - Simply installed

BUY DIRECT FROM THE MANUFACTURER



Planwell

affordable

ROOFING

With the credit crunch set to bite in the sale of new houses, it is predicted that more than 60 percent of homeowners in Scotland will now carry out major improvements to upgrade their properties this year.

Purchasing a new roof from Planwell Roofing Supplies will provide you with real, long term value for your money. Planwell - Best Quality Roofing at Affordable Prices.

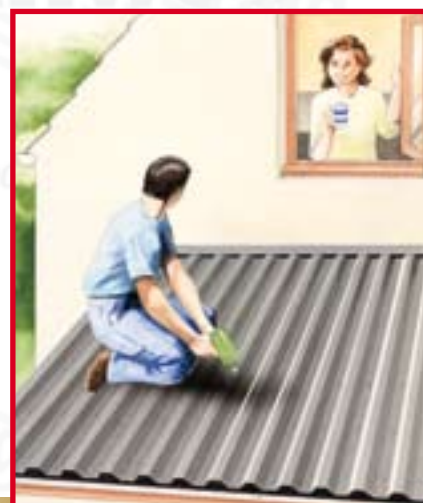

PERMAROOF - SIMPLE INSTALLATION

1989-2009 - 20 years of PLANWELL



FIGURE 1



FIGURE 2



FIGURE 3

VELUX WINDOWS

Planwell **do not recommend** fitting velux windows with their Permaroof range of metal roof sheeting.

Despite this there has been an increase in the last few years in the amount of velux windows being installed by our customers.

The following information is therefore a guide as to how best to carry out any possible installation of velux windows.

- Firstly the minimum fall for this type of window must be achieved, for velux windows this is currently a minimum fall/slope of 15°.
- **Figure 1** shows that a timber frame should be built at least 75mm above the height of the metal roof sheeting. The metal sheeting should then be cut to fit around this.
- **Figure 2** shows flashings fitted around all four sides of the velux. Flashings should be fitted which go up to the timber frame and cover over the complete width of a profile (so that the flashing finishes over the top of the upstand/profile of the metal sheet).
- The area behind the velux should then also be "closed off" by fitting a flat metal sheet flashing (on top of the metal sheet) behind the velux - all the way up to the underside of the top flashing - this will stop any water flowing down the flat sections of the metal sheeting. Any joints on the flat sheet should be given a good overlap (at least 400mm, and should also be sealed with a good quality silicon mastic).
- Foam fillers should be fitted at the bottom flashing (below the velux).
- **Figure 3** shows a flashing then being fitted on top of the timber frame and over the side flashings. These should also be sealed with a good quality silicon mastic.
- All flashings should be fixed by using Planwell's self-drilling screws and colour caps.
- **PLEASE NOTE** it may be that the flashings for around the velux have to be measured and ordered once the sheeting has been cut and installed around the timber frame.

FLASHINGS - in polyester and plastisol

- Planwell manufacture all Permaroof metal flashings (edging) to suit individual requirements.
- Here are examples of the three most popular flashings required.

Permaroof Flashings

- All flashings are manufactured in the Planwell factory to suit your individual requirements
- All flashings are 3m in length
- Flashings are made in materials and colours to match your roofing sheets
- The standard width of a flashing before folding is 400mm (16"), so for example the flashing size can be 200 x 200 or 250 x 150 etc.
- Wider flashings can be provided if required
- Flashings are available in both 0.5mm Polyester and 0.7mm Plastisol material
- All flashings are folded with "safe edges" as standard
- All materials are packed in Planwell's protective wrapping paper
- We have provided just three examples of different types of flashings on this page, for further details please contact our office
- **If you are unsure about what you require then please provide either a sketch and/or a photograph of your roof**



TYPICAL BARGE FLASHING



TYPICAL WALL FLASHING



TYPICAL RIDGE FLASHING

PERMAROOF FLASHINGS

SPECIALLY MANUFACTURED TO SUIT YOUR INDIVIDUAL NEEDS

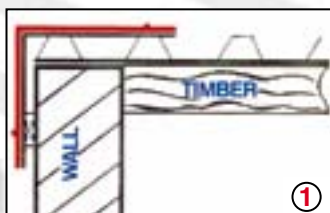

TYPICAL BARGE FLASHING

TYPICAL RIDGE FLASHING

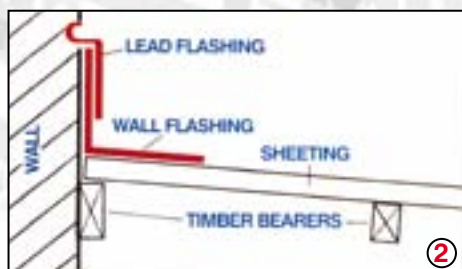
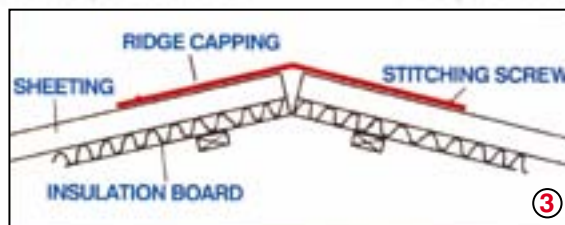

TYPICAL WALL FLASHING

ORDERING INSTRUCTIONS

Please indicate your requirements as per illustration shown right. Use asterisk (*) to denote colour side.

NB. All Flashings are produced in 3 metres lengths only.

NOTE - Flashings wider than standard can be made, please contact Planwell for further details and price.

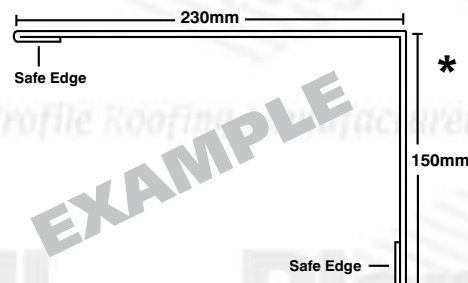

EXAMPLE

PLANWELL - PROVIDE THE COMPLETE ROOFING SERVICE

It is important that you receive proper, professional advice regarding your roof so that the correct type of materials are supplied. With over 30 years of roofing experience, Planwell offer an unbeatable service to all customers. This includes:

- A FREE quotation service
- FREE and proper professional advice
- The best quality roofing materials at the best prices
- All materials manufactured in the Planwell factory to suit your individual requirements
- All flashings manufactured with "safe edges" (as standard)
- All sheets and flashings are packaged with Planwell's reinforced protective paper
- A delivery service throughout mainland Scotland - using our own vehicles 
- FREE fitting guide for simple installation with every order placed
- FREE fixing socket and safety gloves with order placed

**PLANWELL -
UNBEATABLE
SERVICE**



An unbeatable service with thousands of satisfied customers every year, it can only be Planwell Roofing.

THOUSANDS OF SATISFIED CUSTOMERS ALL OVER THE COUNTRY

Mr Hoggan, Fife

“Our club members were delighted with the finished appearance of the roof clad with the materials of our last order.”

Mr Sutherland, Inverness

“Having hunted around for prices elsewhere I found your sheeting to be far and away the cheapest roofing system available. Thanks also for the quick delivery service.”

Mr Inglis, Dundee

“Thank you very much for all the expert fitting advice. I will be recommending you to others.”

Mr Richardson, Aberdeen

“I am delighted with the finished job.”

Mr Smith, Elgin

“The old slated roof has now been renovated and the new profile sheeting has modernised the building.”

Mr Hudson, Orkney

“We have only just recently completed the renovation of our old byre. We are delighted with the results and as you can see we are now enjoying the benefits of a lovely garden room. We are especially pleased with the colour and the roofing profile, we think it fits in very well with the rest of our cottage. Moreover, the roof has kept the building bone dry and has withstood wind gusts of up to 127mph! I am glad now that I used the extra fixings, thanks again for all your help.”

Mr Williams, Ross-shire

“Thank you very much for your prompt service, your driver was very helpful and having fitted the two rooflights there is a good deal of light in my garage.”

Mr Stewart, Fraserburgh

“My joiners fitted the roof in only four hours and the roof's appearance is very good.”

**Mr Robertson,
Inverness**

“It's so simple to fit and the finished roof looks great.”



Large stock of materials at the Planwell Rollform Factory

HOW TO ORDER YOUR ROOF SHEETING

Either complete the Quick Quote form and return this "FREEPOST" to Planwell or telephone/email Planwell when an exact price will be worked out for you then provided to you in writing.

Please then check that all of the details on your quotation are correct. If they are, then sign one of the copies and return your acceptance to Planwell either by email, fax or post.

If there are any details in the quotation that need to be changed then please contact the Planwell office to discuss this.



Planwell Permaroof Sheeting
- designed for roofs and wall cladding

HOW TO PAY

Planwell is a cash and carry business, providing you, the customer, with the best materials at the best prices. Our normal terms are therefore payment in full before your order can be dispatched.

Payment can be made by cheque or cash, we also accept most card types as payment.

Your order will normally be manufactured and dispatched a few days later. Please phone Planwell for further details on your order.

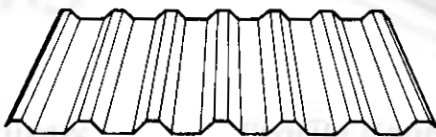

Permaroof COLOUR CHART

SHEET TYPE - POLYESTER ★★★★★



GOOSEWING GREY



SLATE BLUE



VANDYKE BROWN



MERLIN GREY



TERRACOTTA RED



JUNIPER GREEN

SHEET TYPE - PLASTISOL ★★★★★



WHITE



SLATE BLUE



OLIVE GREEN



GOOSEWING GREY



VANDYKE BROWN

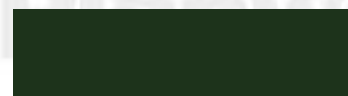

JUNIPER GREEN



MERLIN GREY



BLACK



MOORLAND GREEN

The colours listed above are as a guidance only, due to pigment variations in the printing process the colours may not be exact. For the exact colour please contact Planwell for colour sheet samples. Please note certain colours are only available in Plastisol finish, check with Planwell for further details.

MAKE SURE YOU PLANWELL TODAY!



Profile Roofing Manufacturers

SPECIAL MONTHLY OFFERS

**PLEASE CONTACT PLANWELL
FOR DETAILS OR A PRICE
FOR YOUR NEW ROOF**

**PLEASE EMAIL PLANWELL
FOR OUR COLOUR BROCHURE,
INCLUDING PRICE LIST**

enquiries@planwell.co.uk

A NATIONWIDE DOOR-TO-DOOR DELIVERY SERVICE AVAILABLE

IMPROVE YOUR PROPERTY WITH...

Planwell *affordable* **ROOFING**



BEFORE

AFTER



BEST QUALITY at the RIGHT PRICE

PERMAROOF PIPE SEAL FLASHINGS

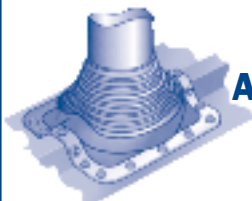

AVAILABLE IN A SELECTION OF SIZES FOR BOTH HOT AND COLD PIPES

TELEPHONE PLANWELL FOR DETAILS

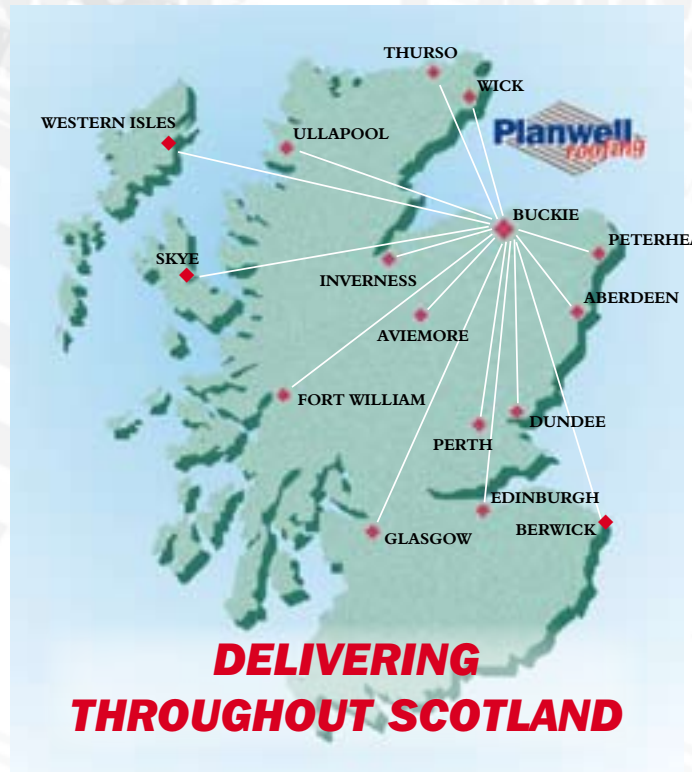

HOW TO FIND US

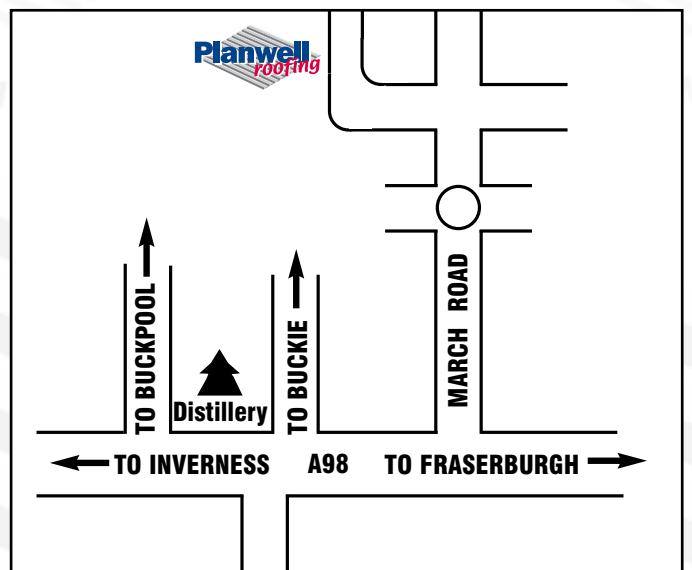

Planwell *roofing*



Profile Roofing Manufacturers

PLANWELL ROOFING SUPPLIES LTD. "THE ROOFING CENTRE" MARCH ROAD INDUSTRIAL ESTATE BUCKIE AB46 4BU

TEL 01542 832170 FAX 01542 832182

email: enquiries@planwell.co.uk

www.planwell.co.uk